

FLASHINGS ARE
EXPANDED TO
SHOW DETAIL.

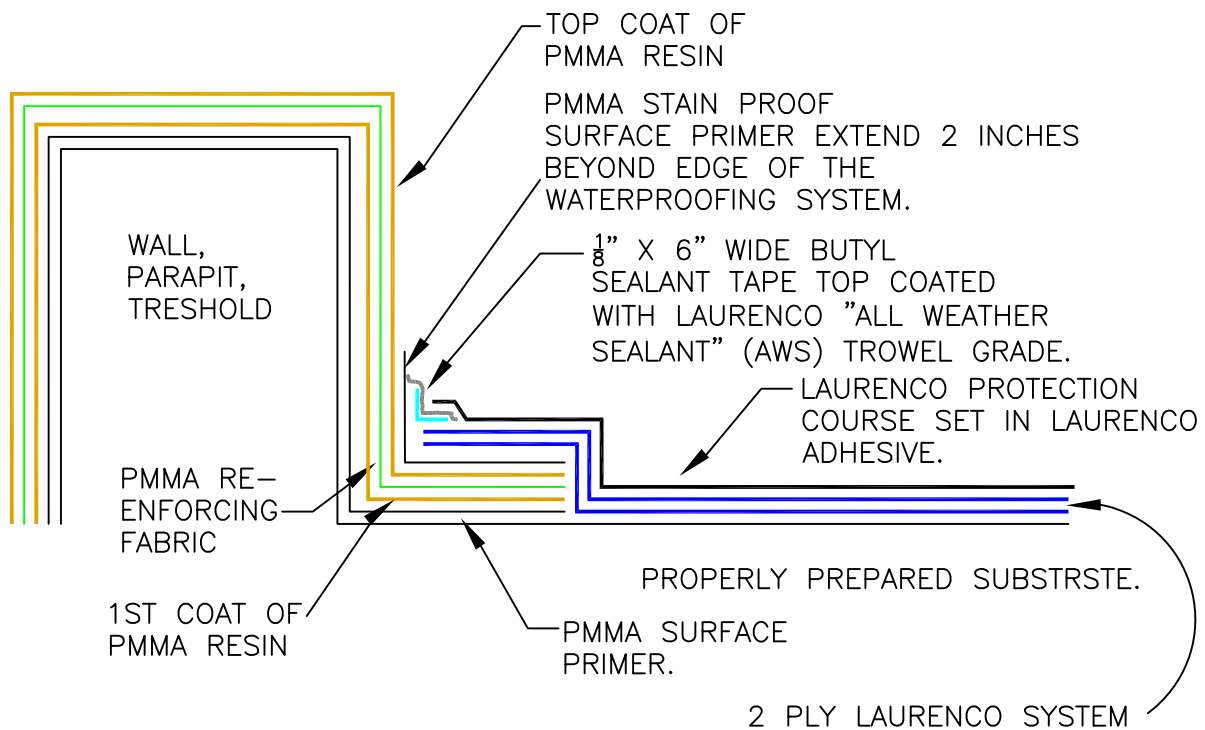

NOTE:

1. DRAIN BOWL AND FLANGE MUST BE PROPERLY PREPARED TO ACCEPT LAURENCO PMMA. PLEASE CHECK WITH LAURENCO TECHNICAL DEPARTMENT FOR PROPER PREPARATION PROCEDURES.
2. LAURENCO PMMA RESIN MUST EXTEND A MINIMUM $\frac{1}{4}$ " BEYOND LAURENCO FLEECE.
3. FOR EXPOSED APPLICATIONS LAURENCO G CAP OR G FR CAP MAY BE SUBSTITUTED FOR THE LAURENCO PROTECTION COURSE.