

STEP 2

NOTE; ASPHALTIC PROTECTION BOARDS CAN NOT BE USED WITHOUT PRIOR WRITTEN

ACCEPTANCE FROM THE LAURENCO TECHNICAL DEPARTMENT. ALL ASPHALTIC PROTECTION BOARDS ARE EXCLUDED FROM LAURENCO WARRANTIES.

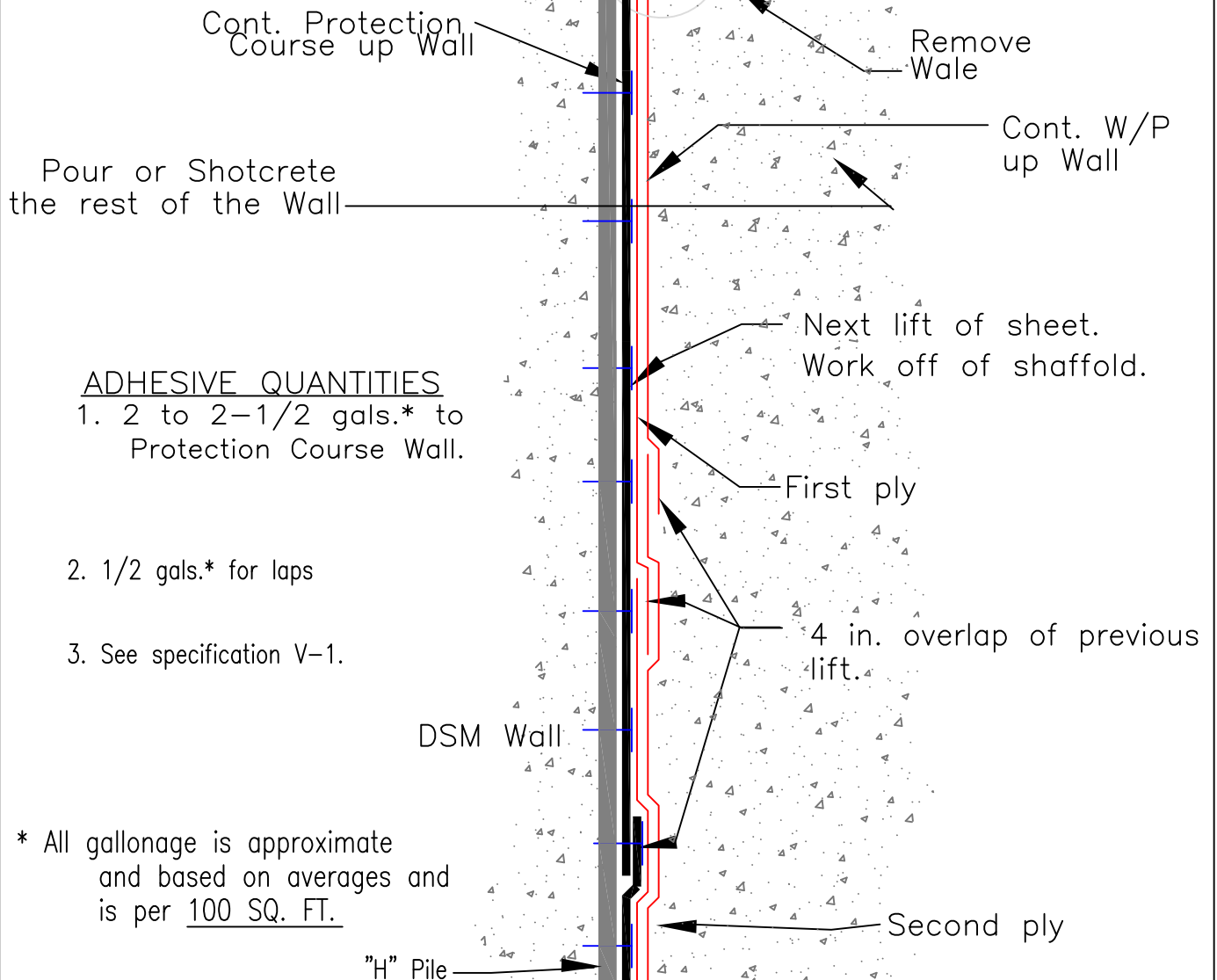

ADHESIVE QUANTITIES

1. 2 to 2-1/2 gals.* to Protection Course Wall.

2. 1/2 gals.* for laps

3. See specification V-1.

* All gallonage is approximate and based on averages and is per 100 SQ. FT.