

STEP #1

CUT BUTYL SEALANT TAPE INTO 4" TO 4" LONG STRIPS. FOR DOWELS & BOLTS $\frac{3}{4}$ " TO $1\frac{1}{4}$ " DIAMETER, ADJUST LENGTH FOR SMALLER OR LARGER DIAMETER PROJECTIONS.

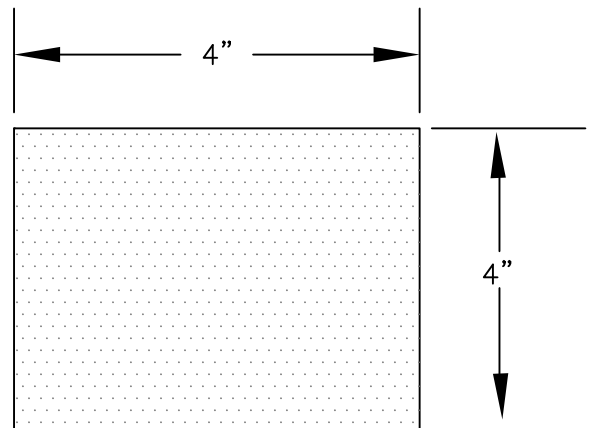

STEP #2

SLIT BUTYL SEALANT TAPE THRU THE MIDDLE $\frac{2}{3}$ OF THE LENGTH AS SHOWN. APPROX. $2\frac{1}{2}$ "

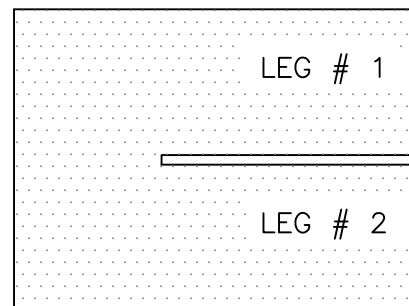

STEP #3

SET BUTYL SEALANT TAPE IN A PRIME COAT OF ADHESIVE APPLIED OVER WATERPROOFING OR PROTECTION BOARD. WORK TAPE AROUND DOWEL OVERLAPPING LEG #2 OVER LEG #1, SHOWN IN STEP #4.

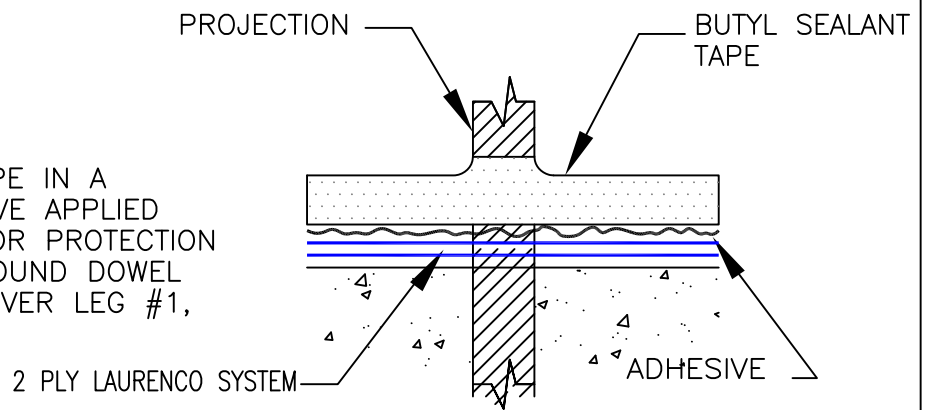

STEP #4

AFTER OVERLAPPING THE TWO LEGS OF THE TAPE AROUND PROJECTION COMPRESS TAPE FIRMLY TO SEAL.

NOTE: WHEN WORKING WITH TAPE USE A CAN OF WATER AS SOURCE TO WET FINGERS, SCISSORS, KNIVES, ETC.

